

Appendix A
USFS Sensitive
Species Occurrences
MS-017 - 5/24/2010

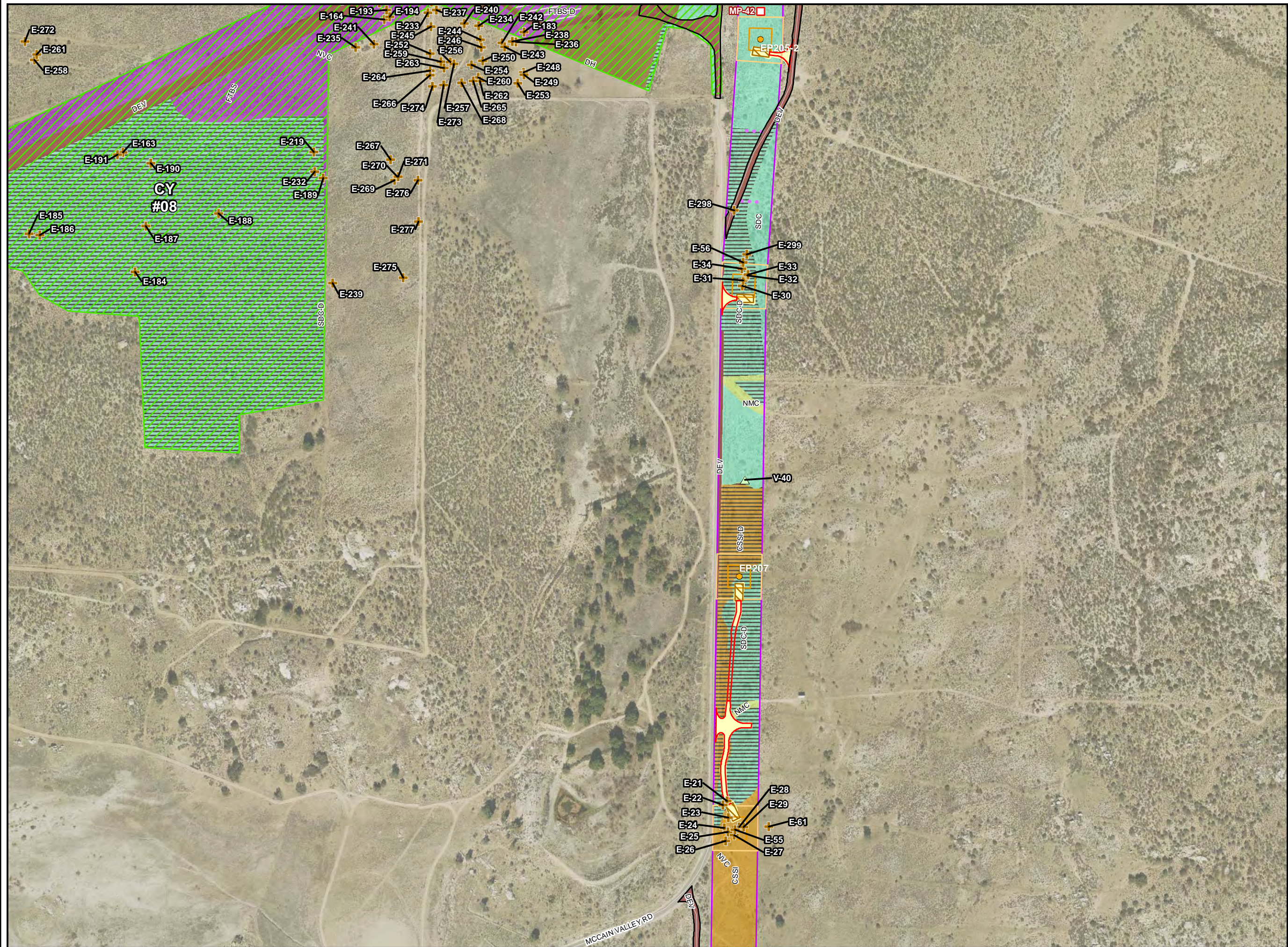



SUNRISE POWERLINKSM

- MP-51 Mile Marker
- P16-1 Current Sunrise Structure
- Guard Structure
- TSAP (Tower Staging Access Pad)
- Existing Road Needing Major Reconstruction
- Existing Road Needing Minor Grading
- Access Road to be Constructed
- Temporary Access Road
- Existing Road Ready to Use
- Suncrest Substation
- Substation Impact Area
- Maintenance Pad
- Structure Pad Area
- Grading Limits
- Construction Yard
- Temporary Pull Site
- Structure Work Area
- Cleveland National Forest Congressional Boundary
- USFS Owned Land



0 400 800

Feet

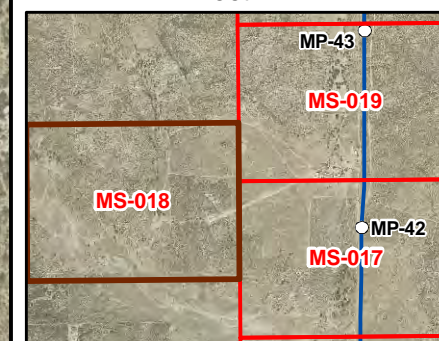

Appendix A
USFS Sensitive
Species Occurrences
MS-018 - 5/24/2010



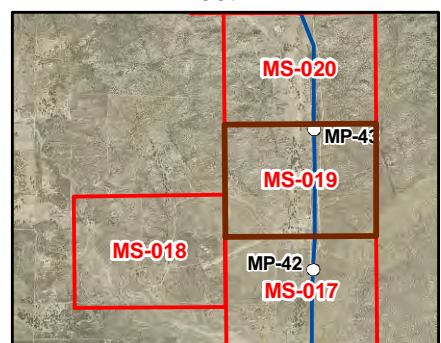
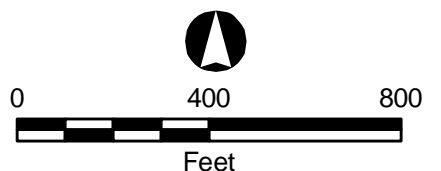
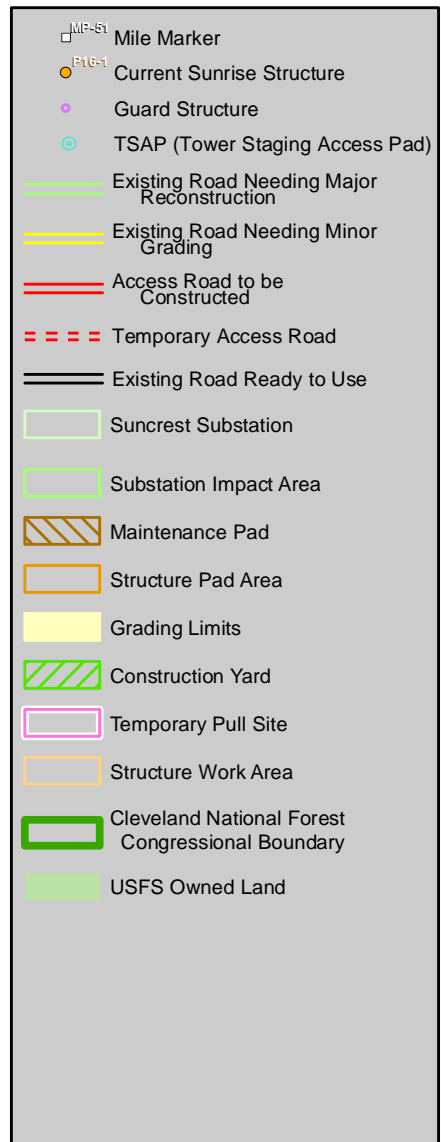

Appendix A
USFS Sensitive
Species Occurrences
MS-019 - 5/24/2010



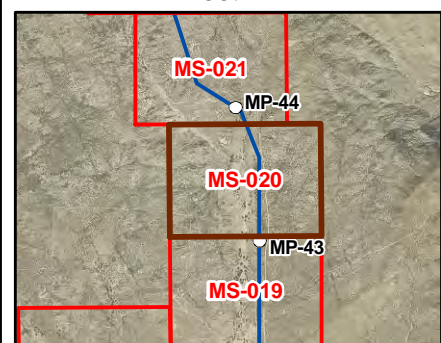
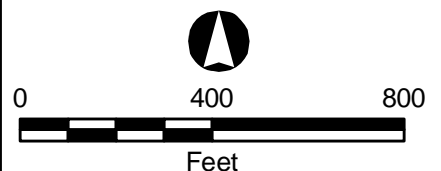
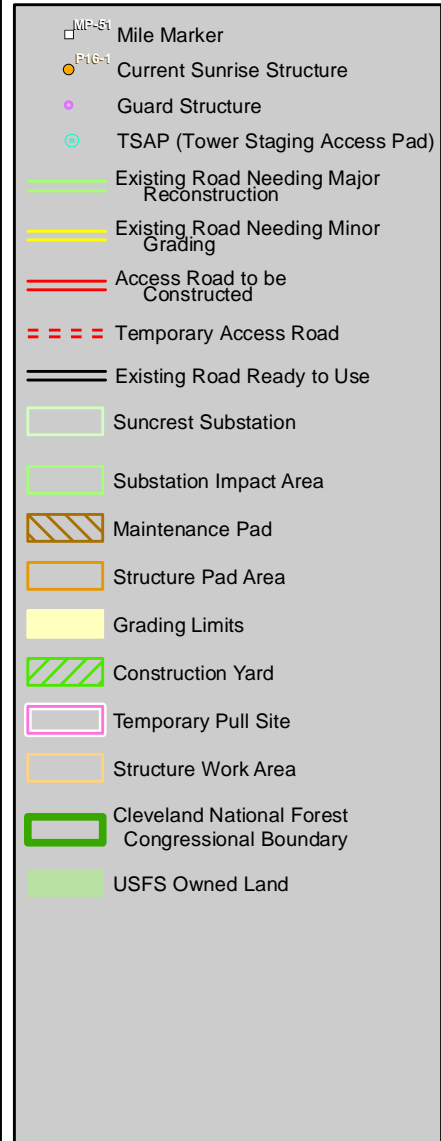

Appendix A
USFS Sensitive
Species Occurrences
MS-020 - 5/24/2010

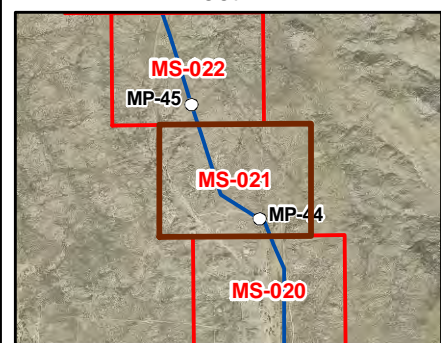
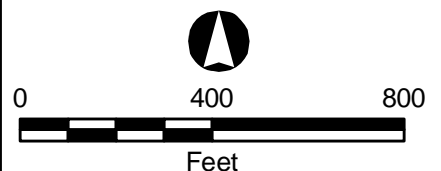
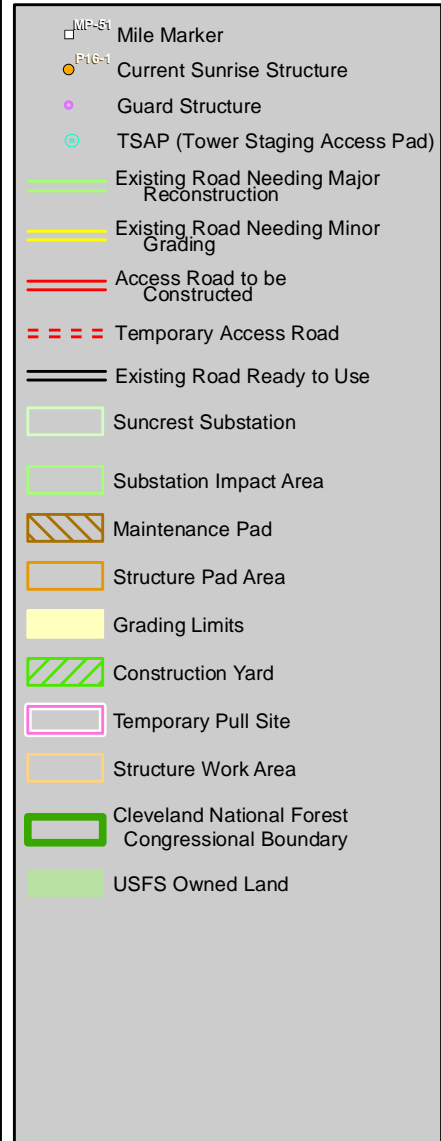

Appendix A
USFS Sensitive
Species Occurrences
MS-021 - 5/24/2010

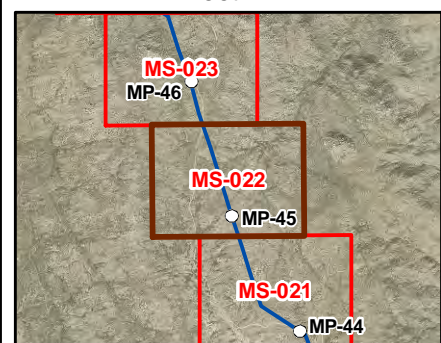
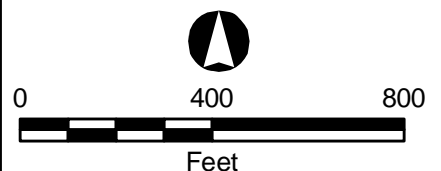
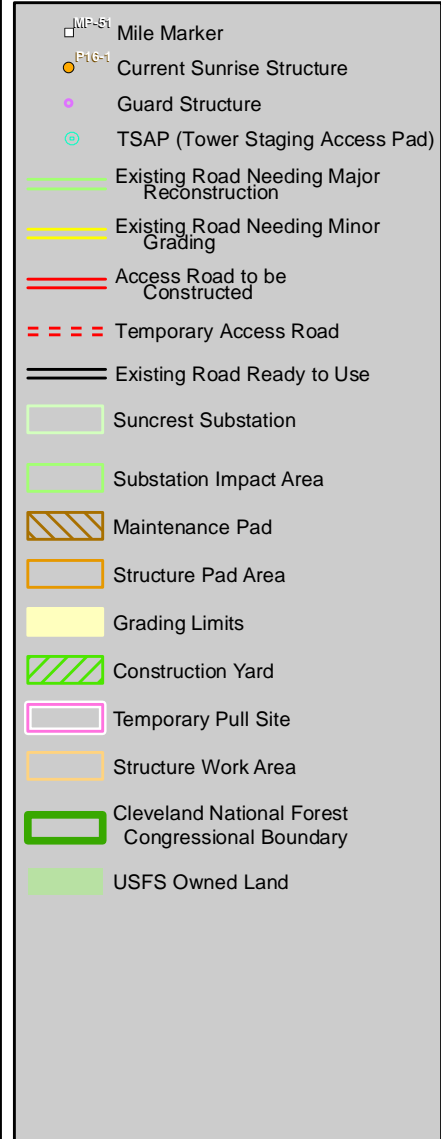

Appendix A
USFS Sensitive
Species Occurrences
MS-022 - 5/24/2010

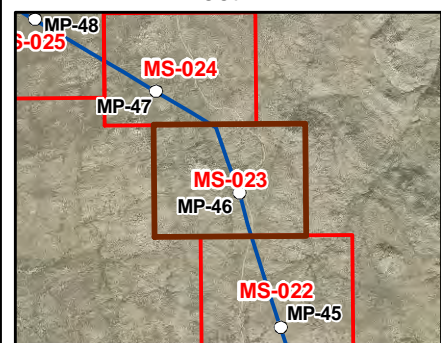
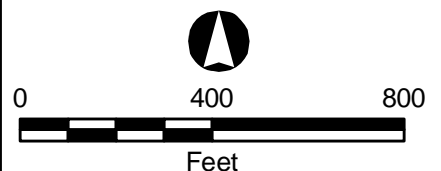
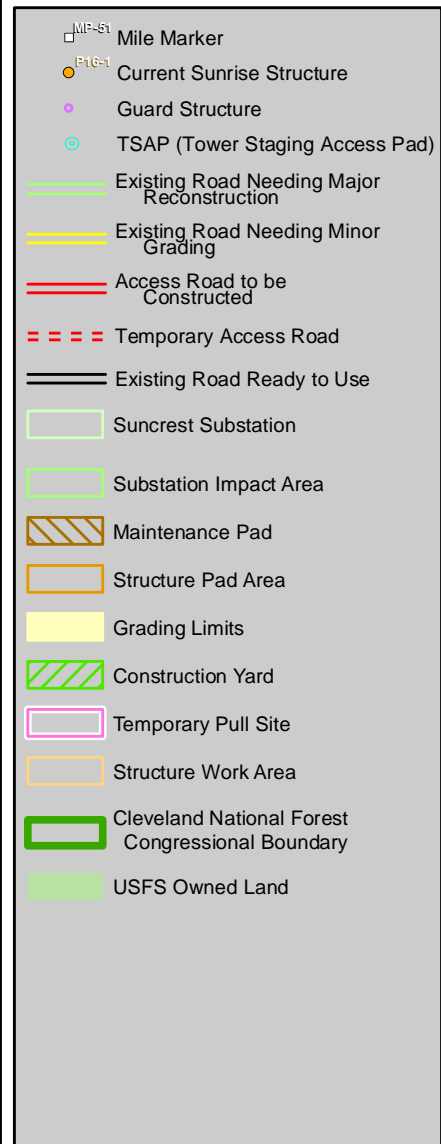

Appendix A
USFS Sensitive
Species Occurrences
MS-023 - 5/24/2010

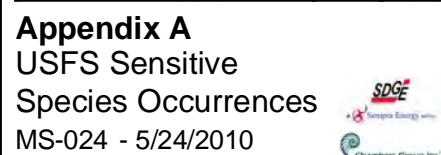
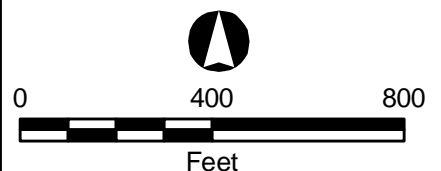

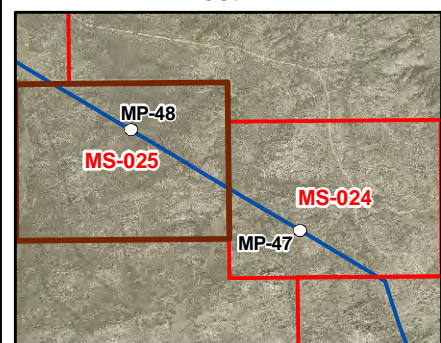
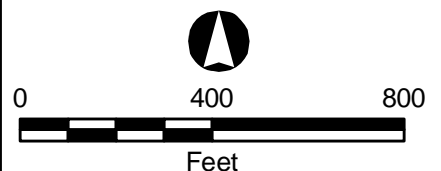
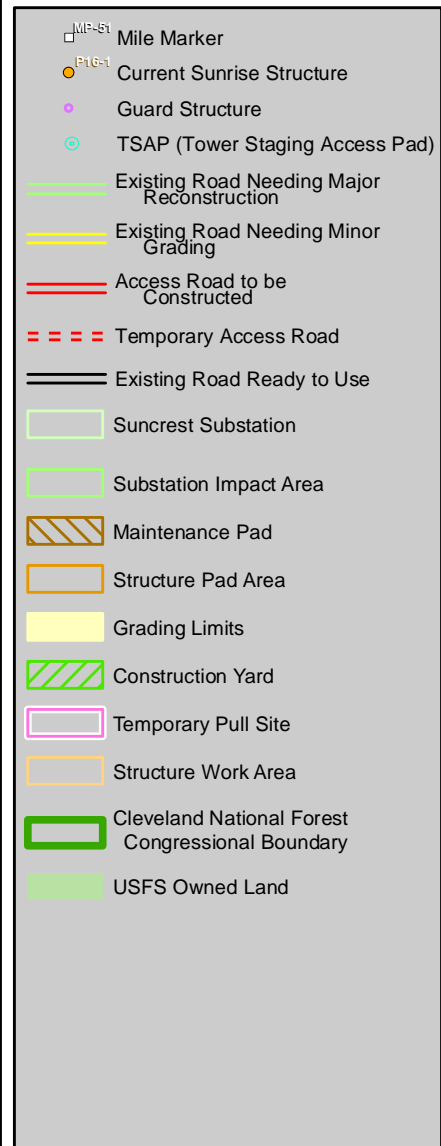

Appendix A
USFS Sensitive
Species Occurrences
MS-025 - 5/24/2010

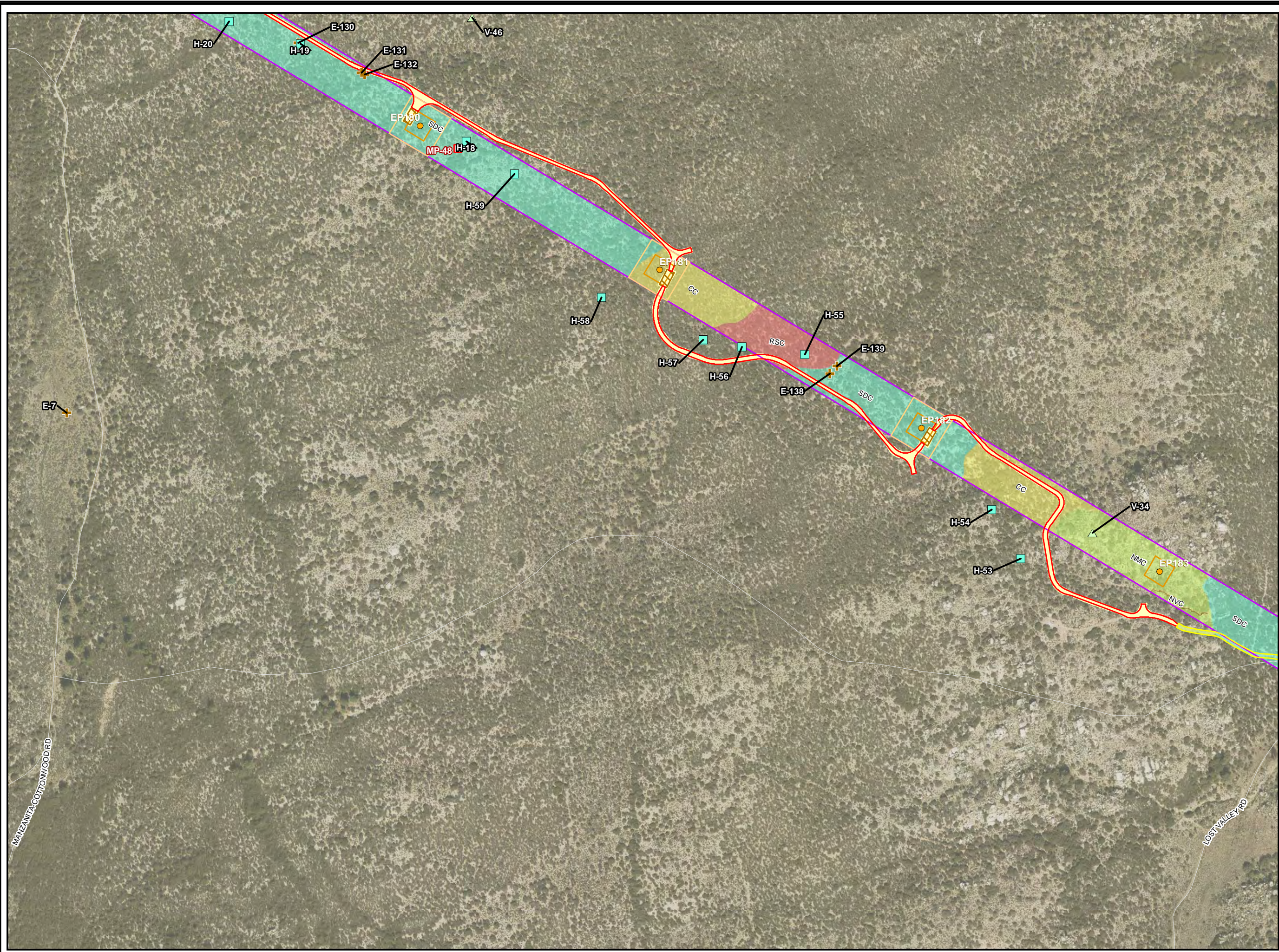



SUNRISE POWERLINKSM

- MP-51 Mile Marker
- P16-1 Current Sunrise Structure
- Guard Structure
- TSAP (Tower Staging Access Pad)
- Existing Road Needing Major Reconstruction
- Existing Road Needing Minor Grading
- Access Road to be Constructed
- Temporary Access Road
- Existing Road Ready to Use
- Suncrest Substation
- Substation Impact Area
- Maintenance Pad
- Structure Pad Area
- Grading Limits
- Construction Yard
- Temporary Pull Site
- Structure Work Area
- Cleveland National Forest Congressional Boundary
- USFS Owned Land



0 400 800
Feet

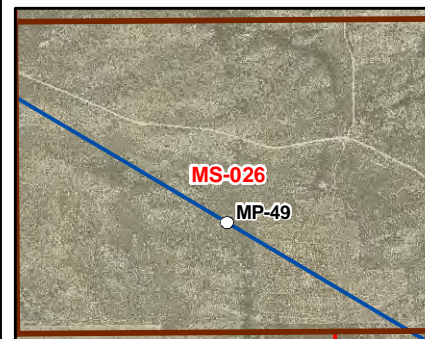

Appendix A
USFS Sensitive
Species Occurrences
MS-026 - 5/24/2010



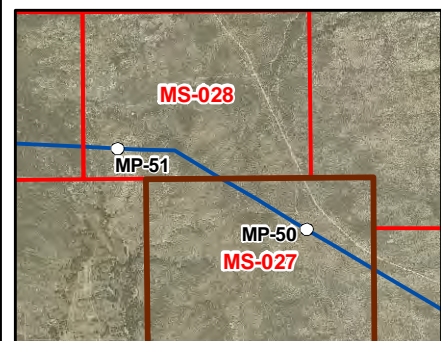
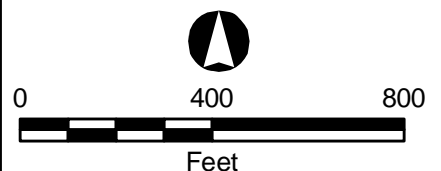
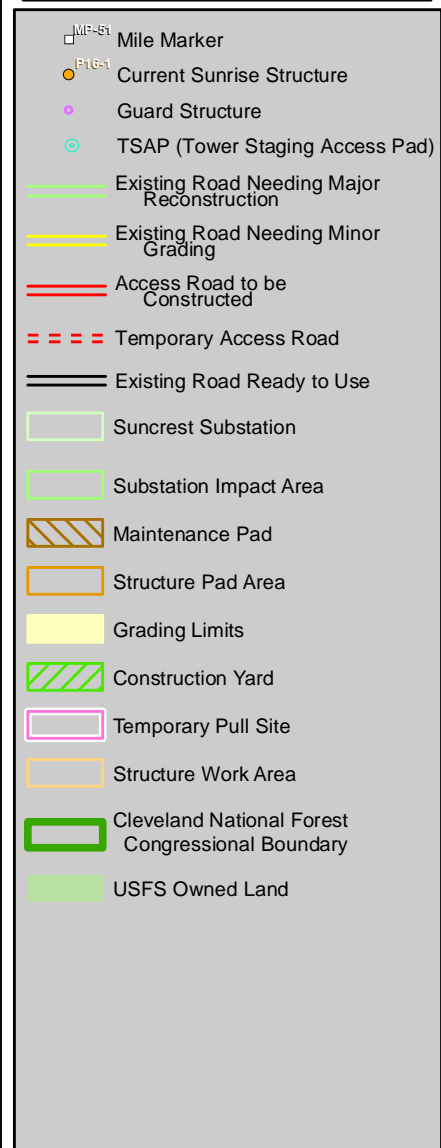

Appendix A
USFS Sensitive
Species Occurrences
MS-027 - 5/24/2010

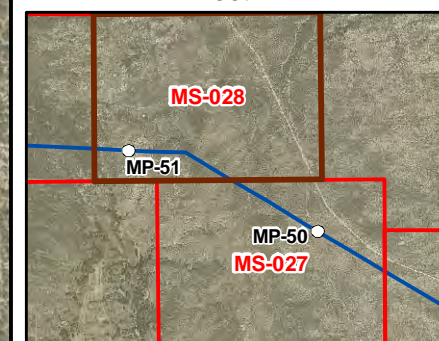
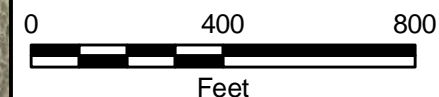
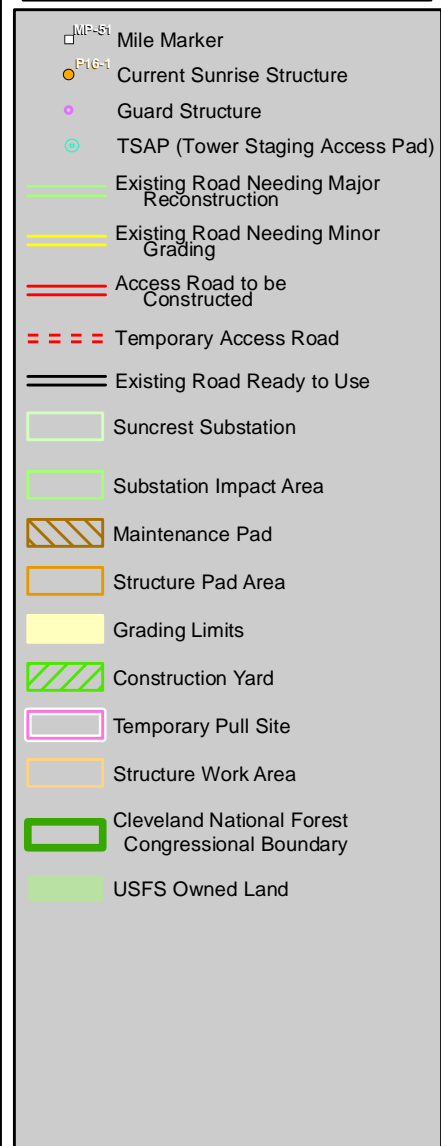

Appendix A
USFS Sensitive
Species Occurrences
MS-028 - 5/24/2010

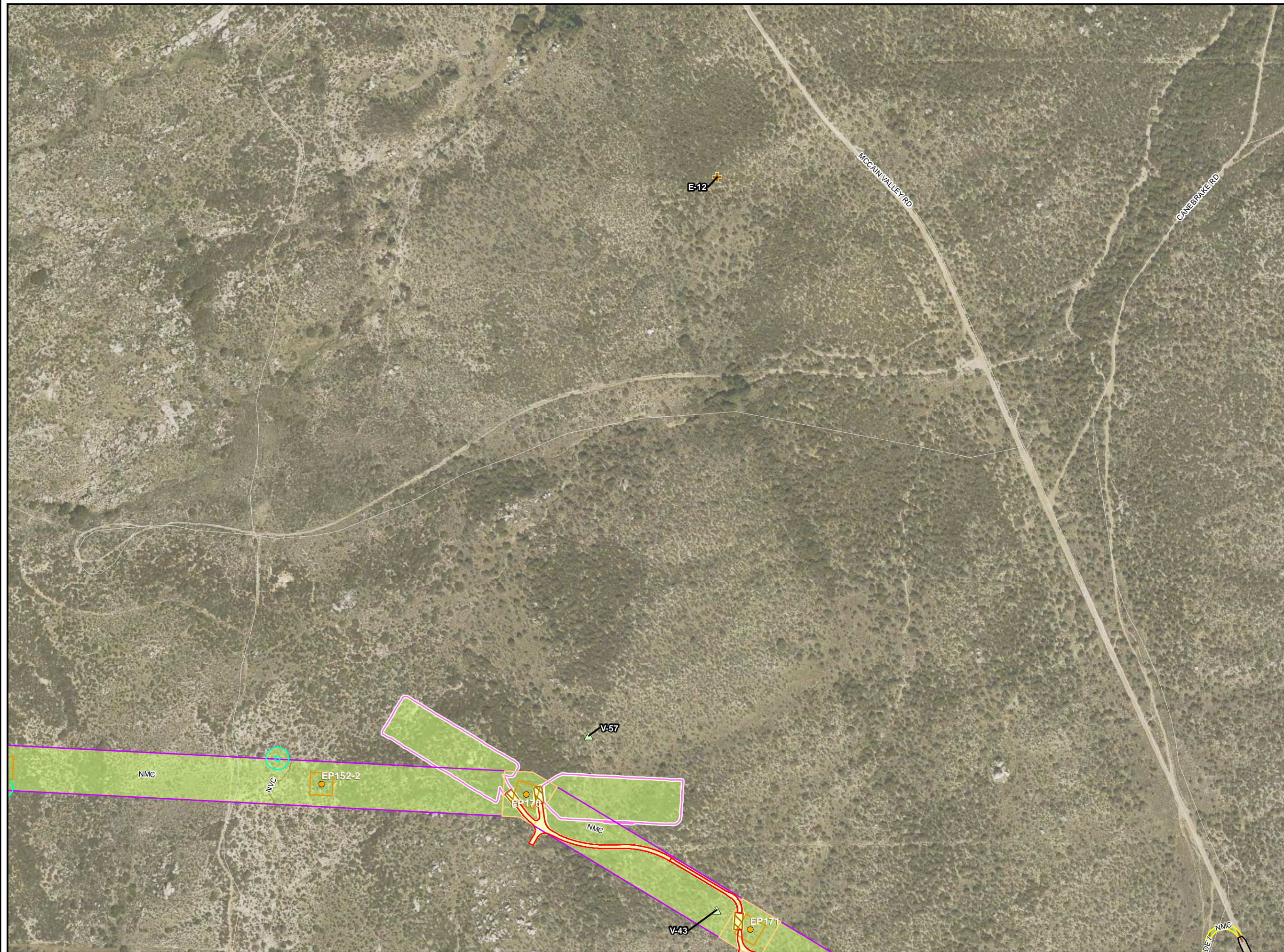

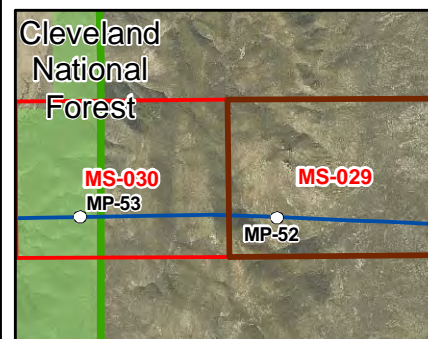
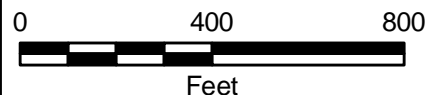
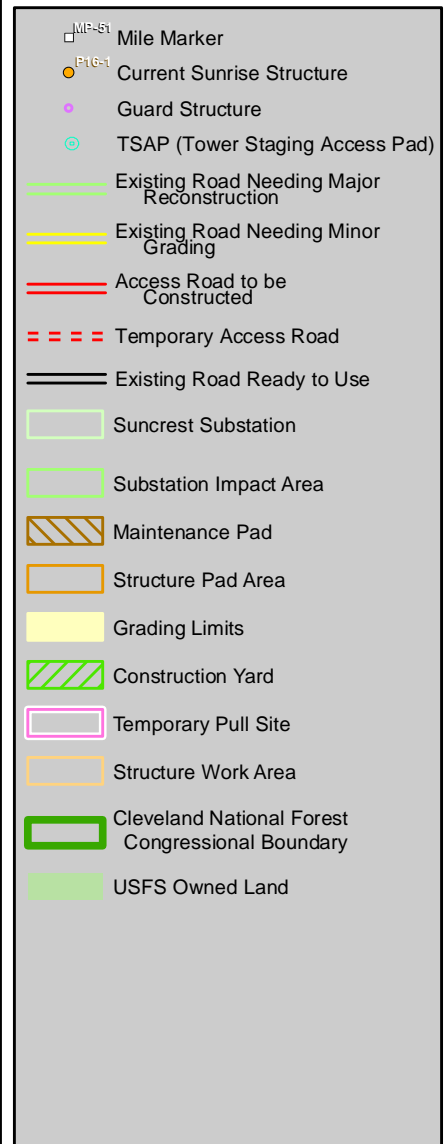

Appendix A
USFS Sensitive
Species Occurrences
MS-029 - 5/24/2010

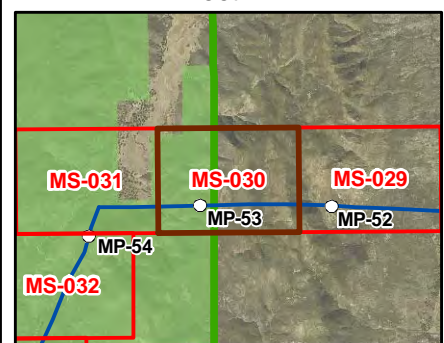
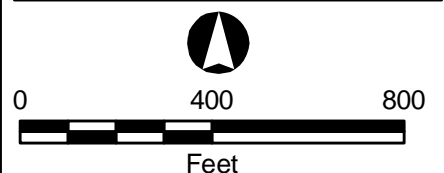
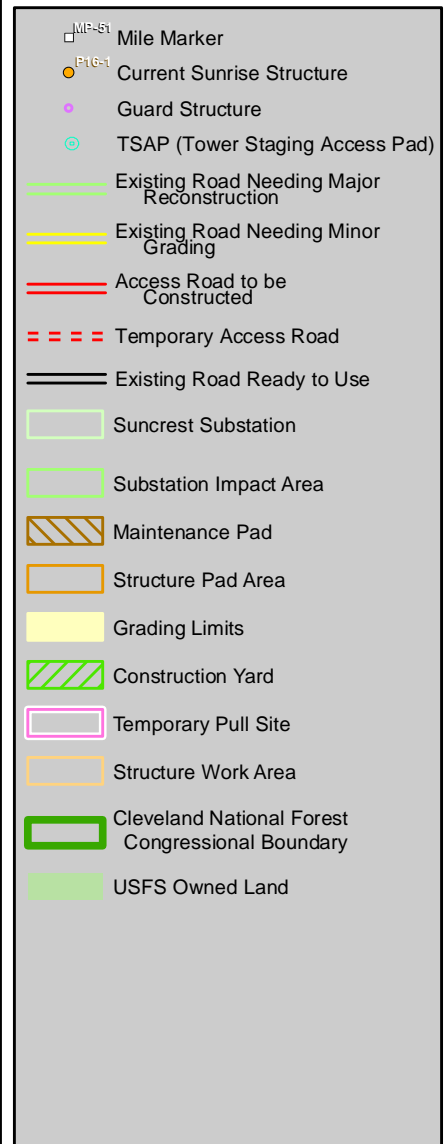

Appendix A
USFS Sensitive
Species Occurrences
MS-030 - 5/24/2010

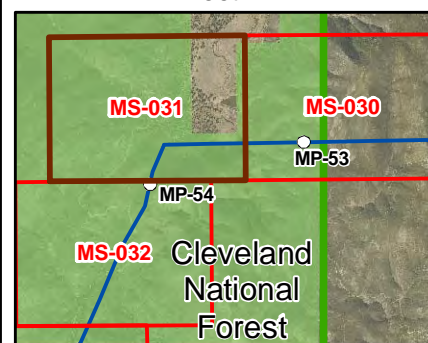
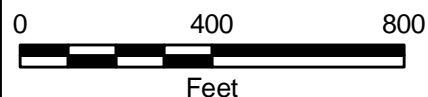
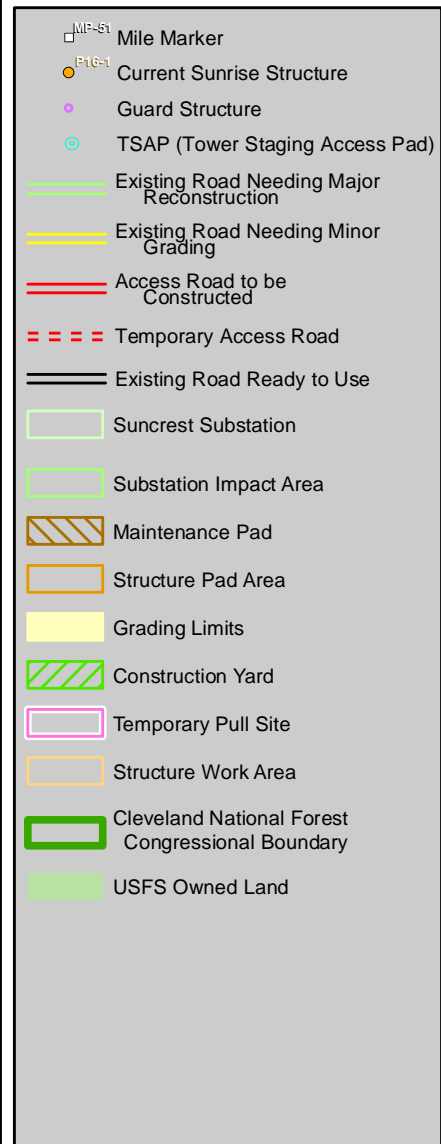

Appendix A
USFS Sensitive
Species Occurrences
MS-031 - 5/24/2010

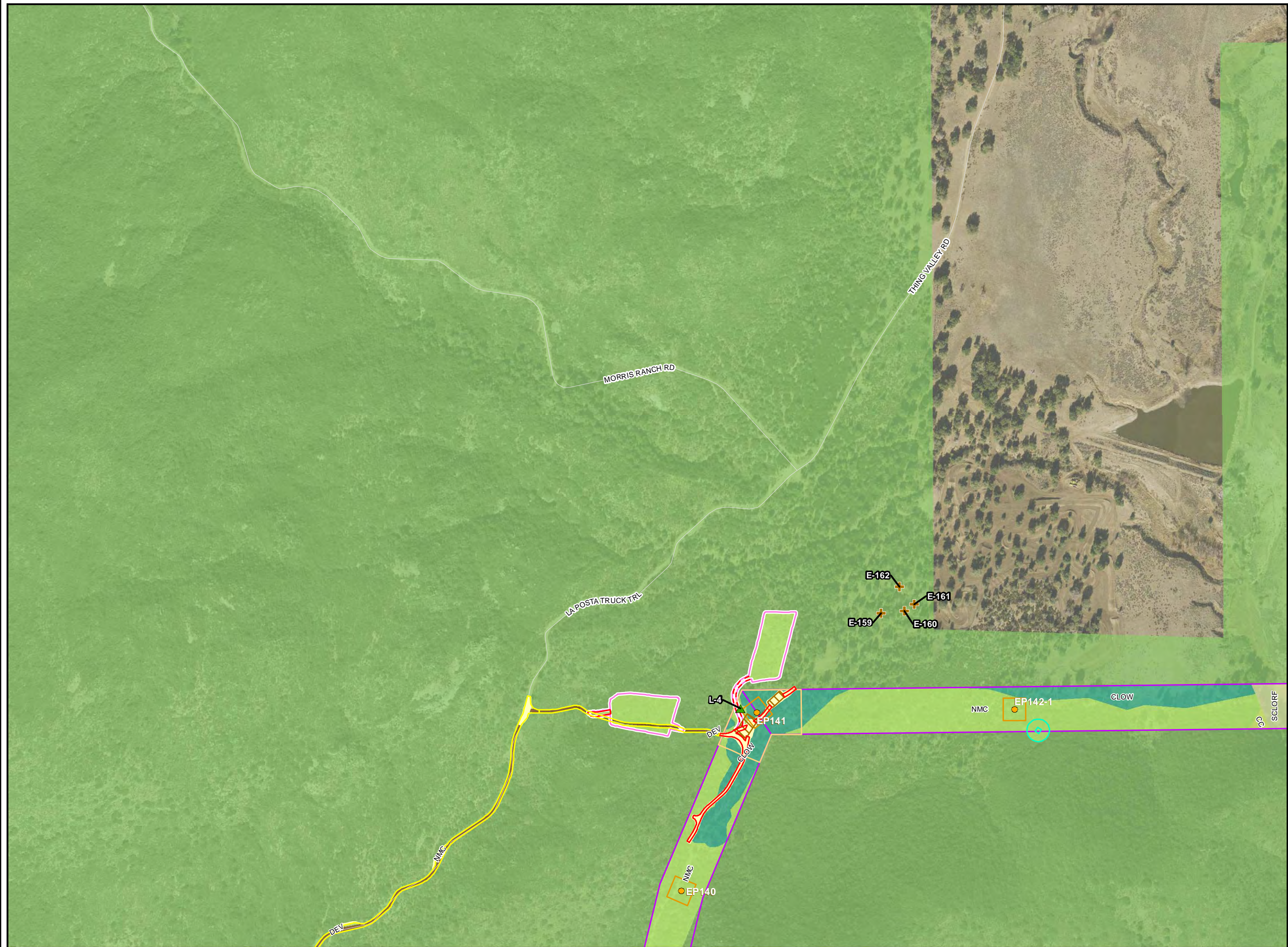

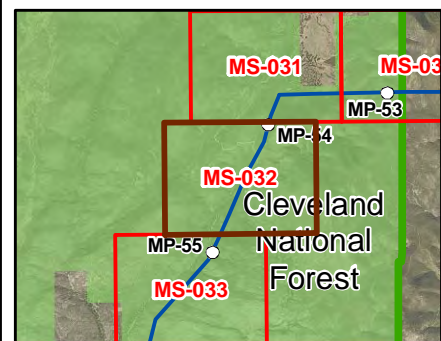
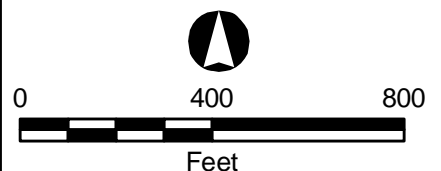
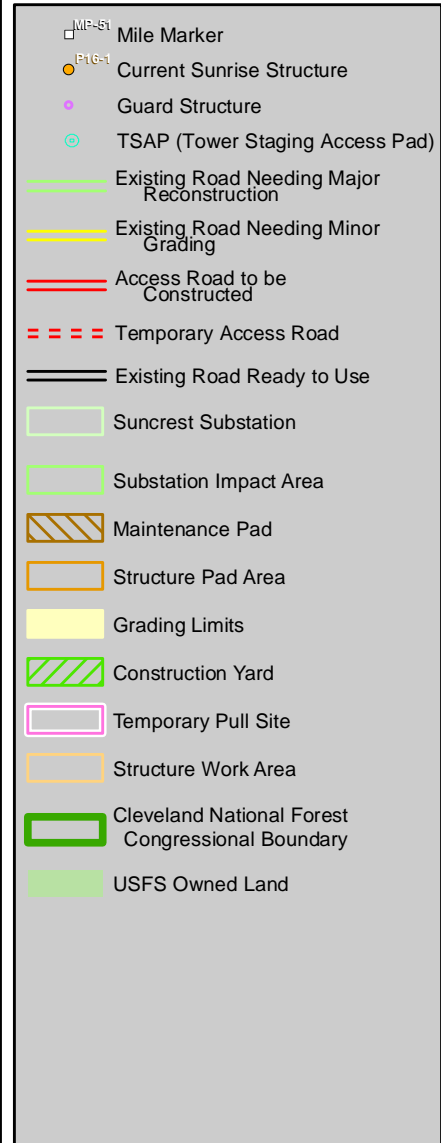

Appendix A
USFS Sensitive
Species Occurrences
MS-032 - 5/24/2010



SUNRISE POWERLINKSM

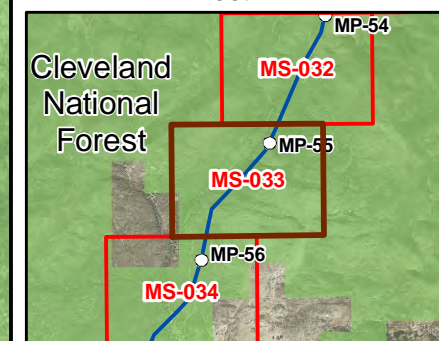
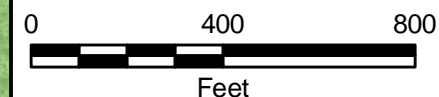
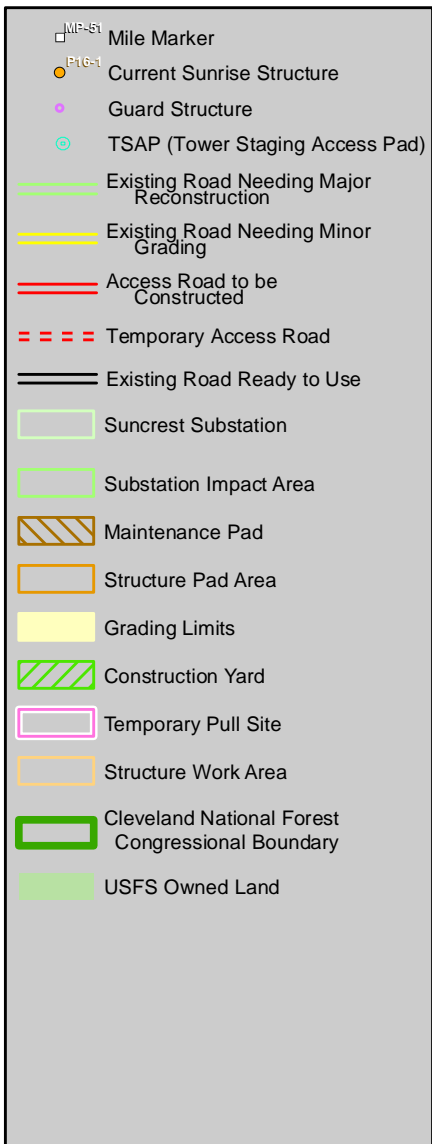

Appendix A
USFS Sensitive
Species Occurrences
MS-033 - 5/24/2010



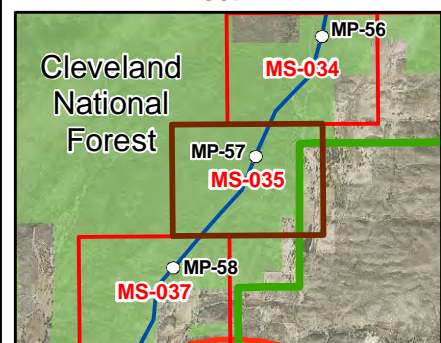
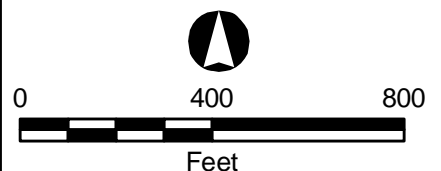
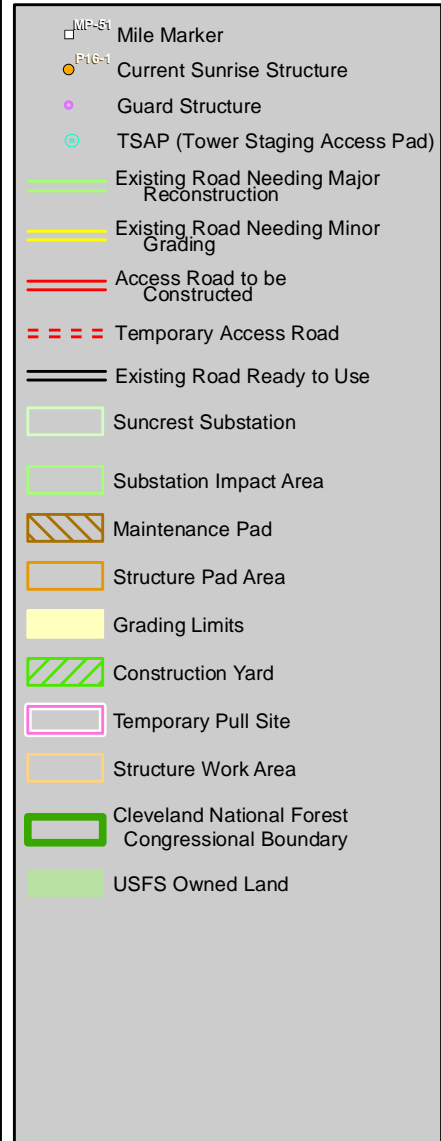

Appendix A
USFS Sensitive
Species Occurrences
MS-035 - 5/24/2010





SUNRISE POWERLINKSM

- MP-51 Mile Marker
- P10-1 Current Sunrise Structure
- Guard Structure
- TSAP (Tower Staging Access Pad)
- Existing Road Needing Major Reconstruction
- Existing Road Needing Minor Grading
- Access Road to be Constructed
- Temporary Access Road
- Existing Road Ready to Use
- Suncrest Substation
- Substation Impact Area
- Maintenance Pad
- Structure Pad Area
- Grading Limits
- Construction Yard
- Temporary Pull Site
- Structure Work Area
- Cleveland National Forest Congressional Boundary
- USFS Owned Land



0 400 800
Feet

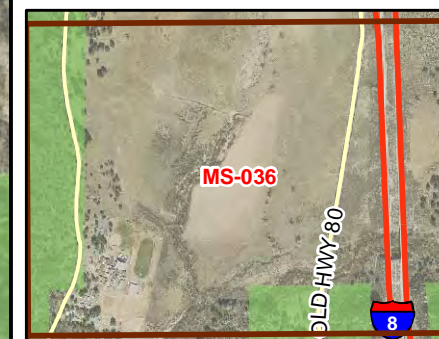

Appendix A
USFS Sensitive
Species Occurrences
MS-036 - 5/24/2010





SUNRISE POWERLINKSM

- MP-51 Mile Marker
- P10-1 Current Sunrise Structure
- Guard Structure
- TSAP (Tower Staging Access Pad)
- Existing Road Needing Major Reconstruction
- Existing Road Needing Minor Grading
- Access Road to be Constructed
- Temporary Access Road
- Existing Road Ready to Use
- Suncrest Substation
- Substation Impact Area
- Maintenance Pad
- Structure Pad Area
- Grading Limits
- Construction Yard
- Temporary Pull Site
- Structure Work Area
- Cleveland National Forest Congressional Boundary
- USFS Owned Land



0 400 800

Feet

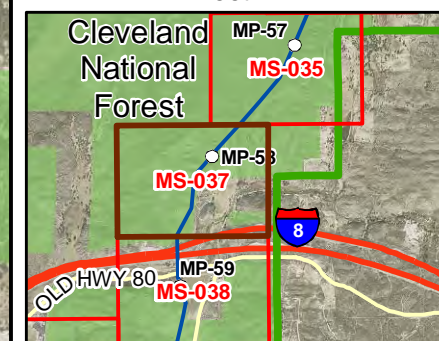

Appendix A
USFS Sensitive
Species Occurrences
MS-037 - 5/24/2010



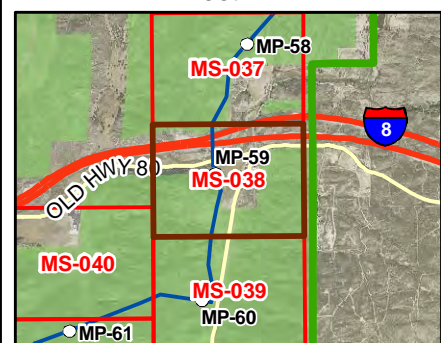
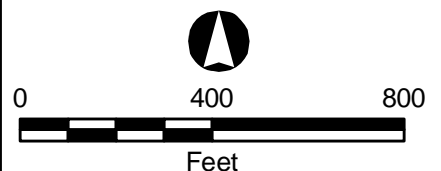
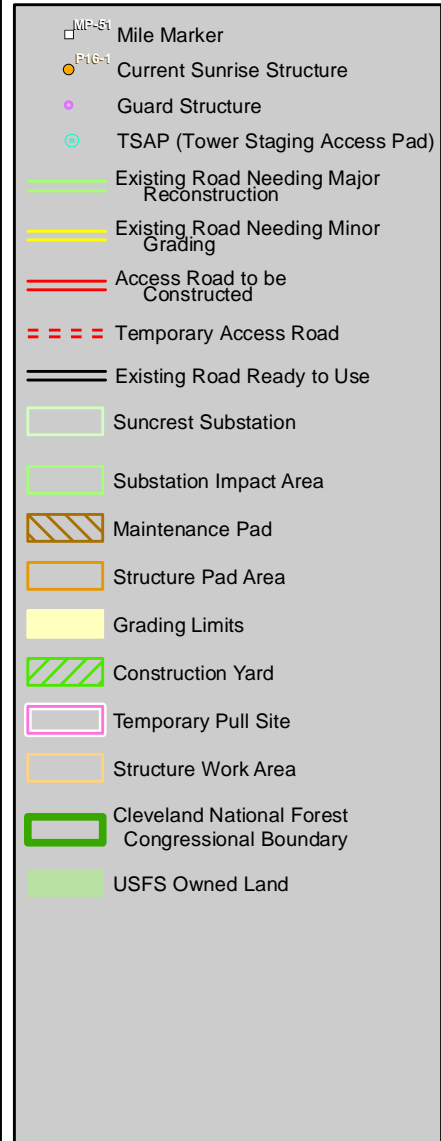

Appendix A
USFS Sensitive
Species Occurrences
MS-038 - 5/24/2010



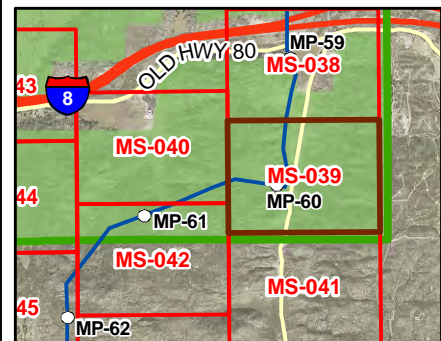
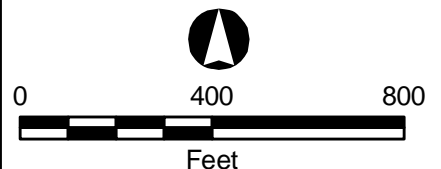
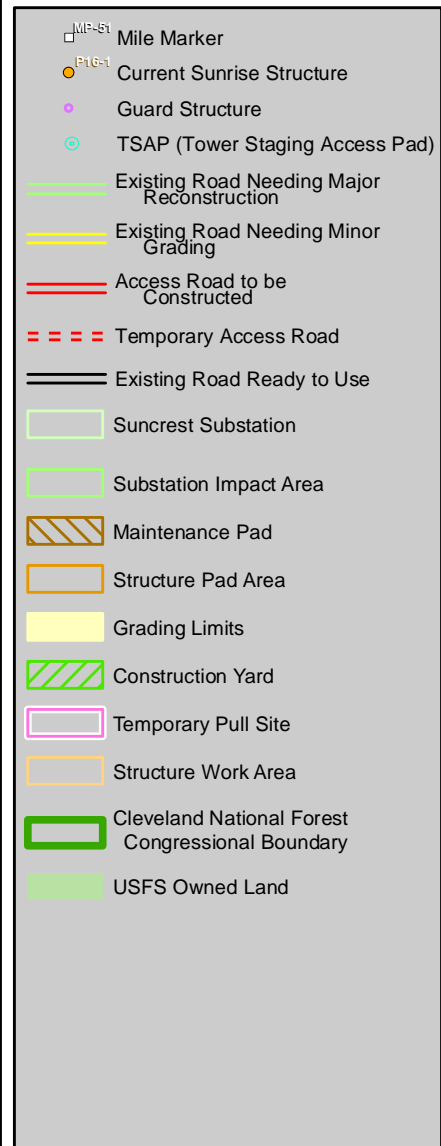

Appendix A
USFS Sensitive
Species Occurrences
MS-039 - 5/24/2010

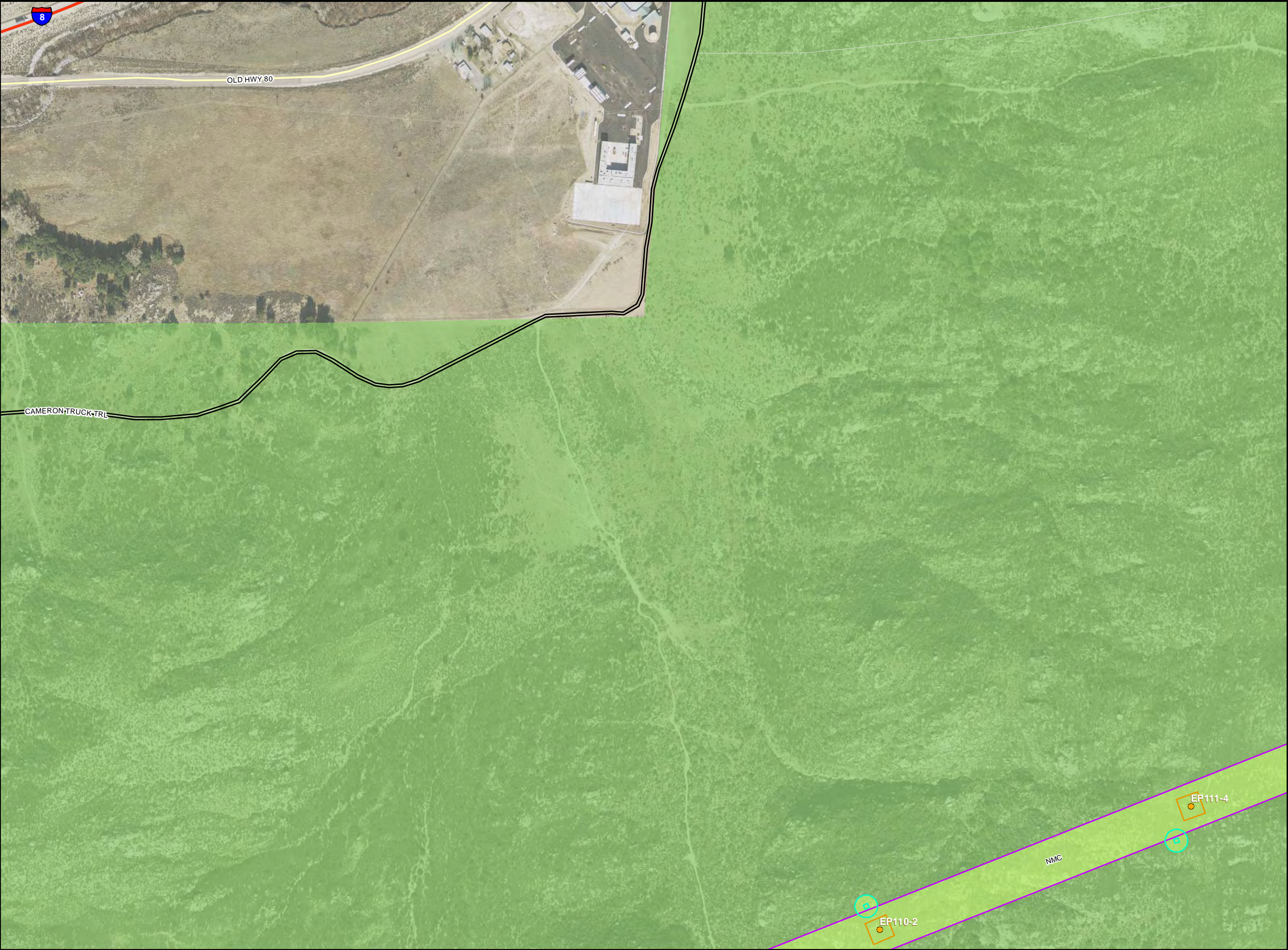

- MP-61 Mile Marker
- P10-1 Current Sunrise Structure
- Guard Structure
- TSAP (Tower Staging Access Pad)
- Existing Road Needing Major Reconstruction
- Existing Road Needing Minor Grading
- Access Road to be Constructed
- Temporary Access Road
- Existing Road Ready to Use
- Suncrest Substation
- Substation Impact Area
- Maintenance Pad
- Structure Pad Area
- Grading Limits
- Construction Yard
- Temporary Pull Site
- Structure Work Area
- Cleveland National Forest Congressional Boundary
- USFS Owned Land

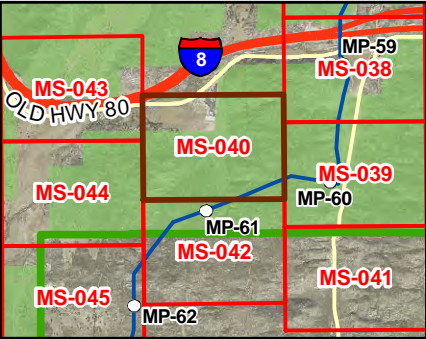
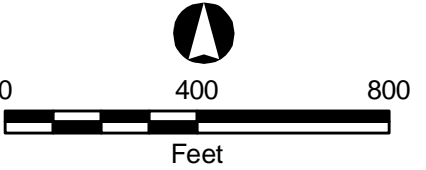



- MP-61 Mile Marker
- P16-1 Current Sunrise Structure
- Guard Structure
- TSAP (Tower Staging Access Pad)
- Existing Road Needing Major Reconstruction
- Existing Road Needing Minor Grading
- Access Road to be Constructed
- Temporary Access Road
- Existing Road Ready to Use
- Suncrest Substation
- Substation Impact Area
- Maintenance Pad
- Structure Pad Area
- Grading Limits
- Construction Yard
- Temporary Pull Site
- Structure Work Area
- Cleveland National Forest Congressional Boundary
- USFS Owned Land

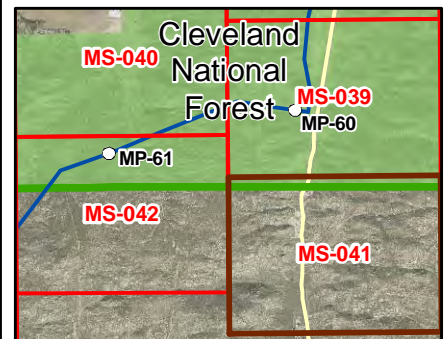
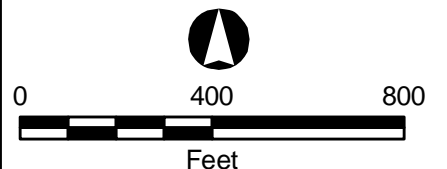

Appendix A
USFS Sensitive
Species Occurrences
MS-041 - 5/24/2010



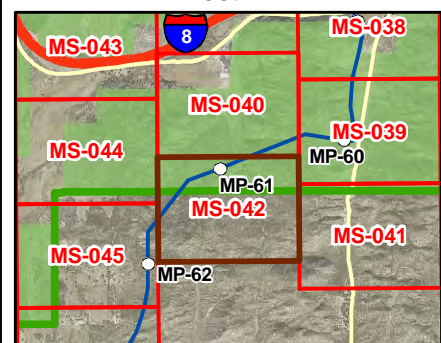
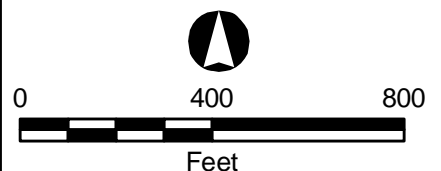
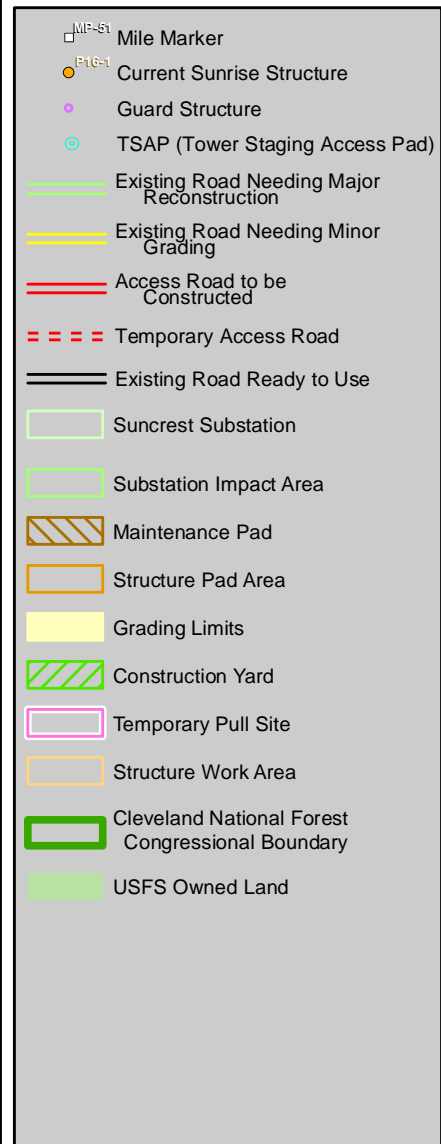

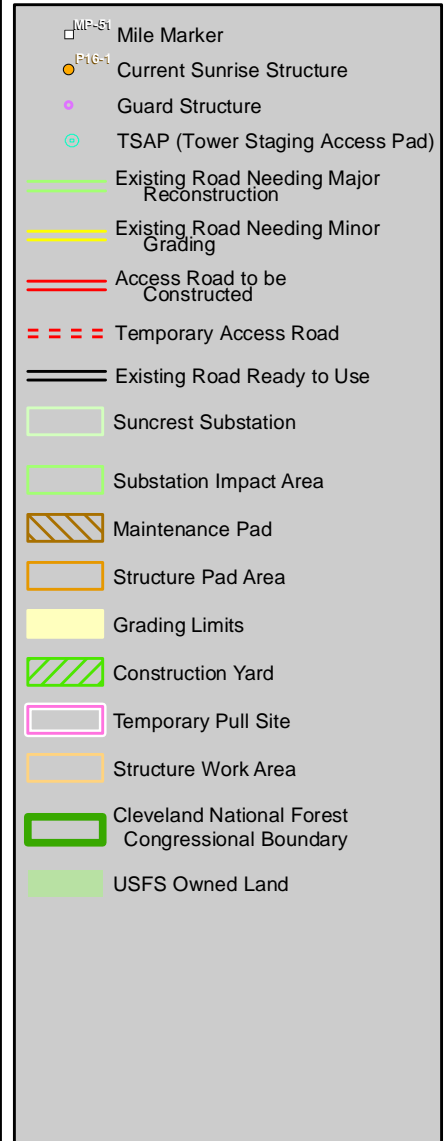

0 400 800
Feet

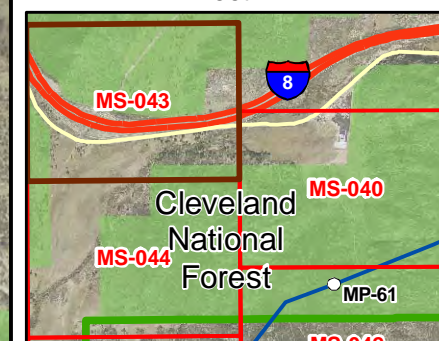

Appendix A
USFS Sensitive
Species Occurrences
MS-043 - 5/24/2010

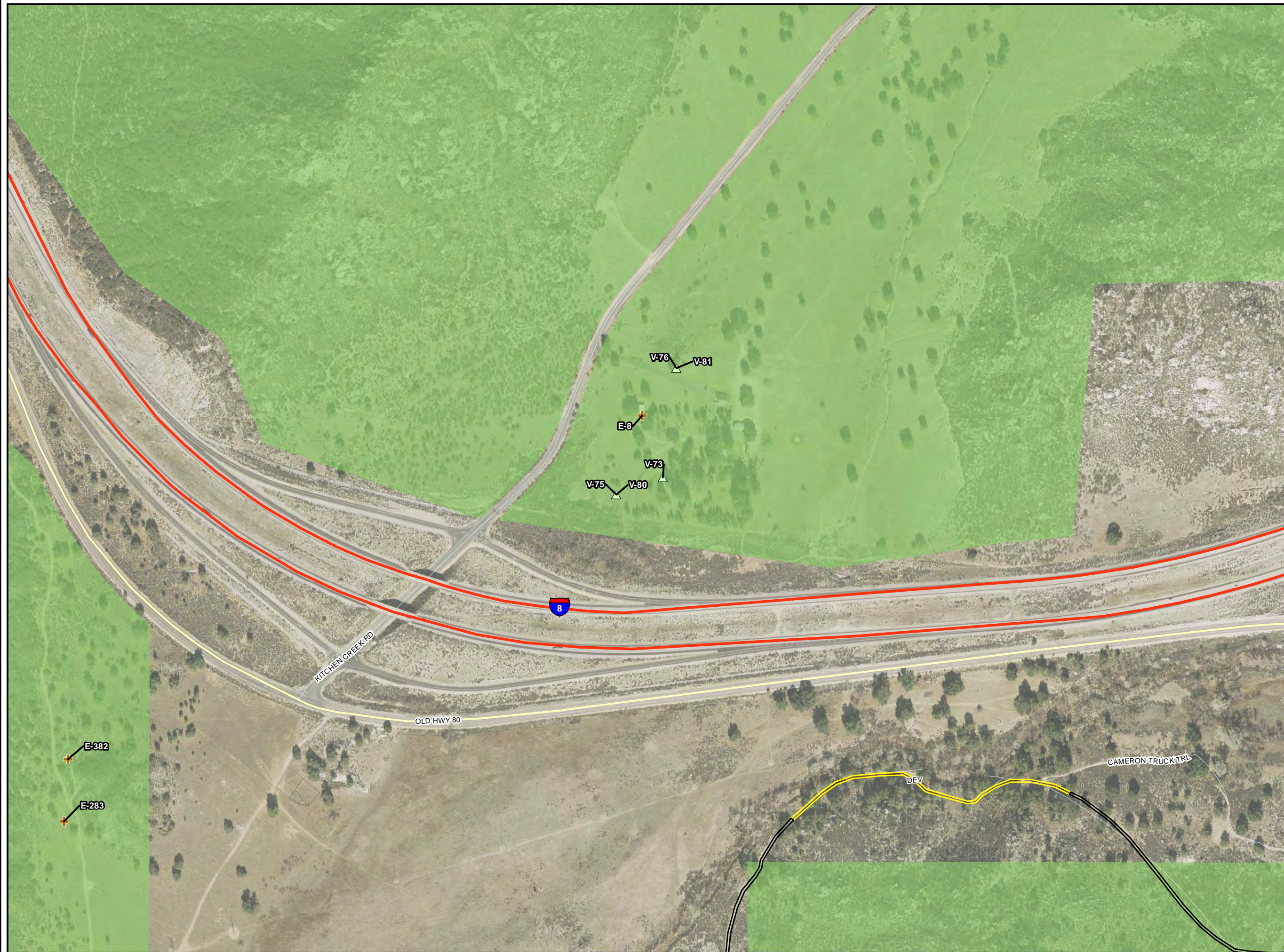

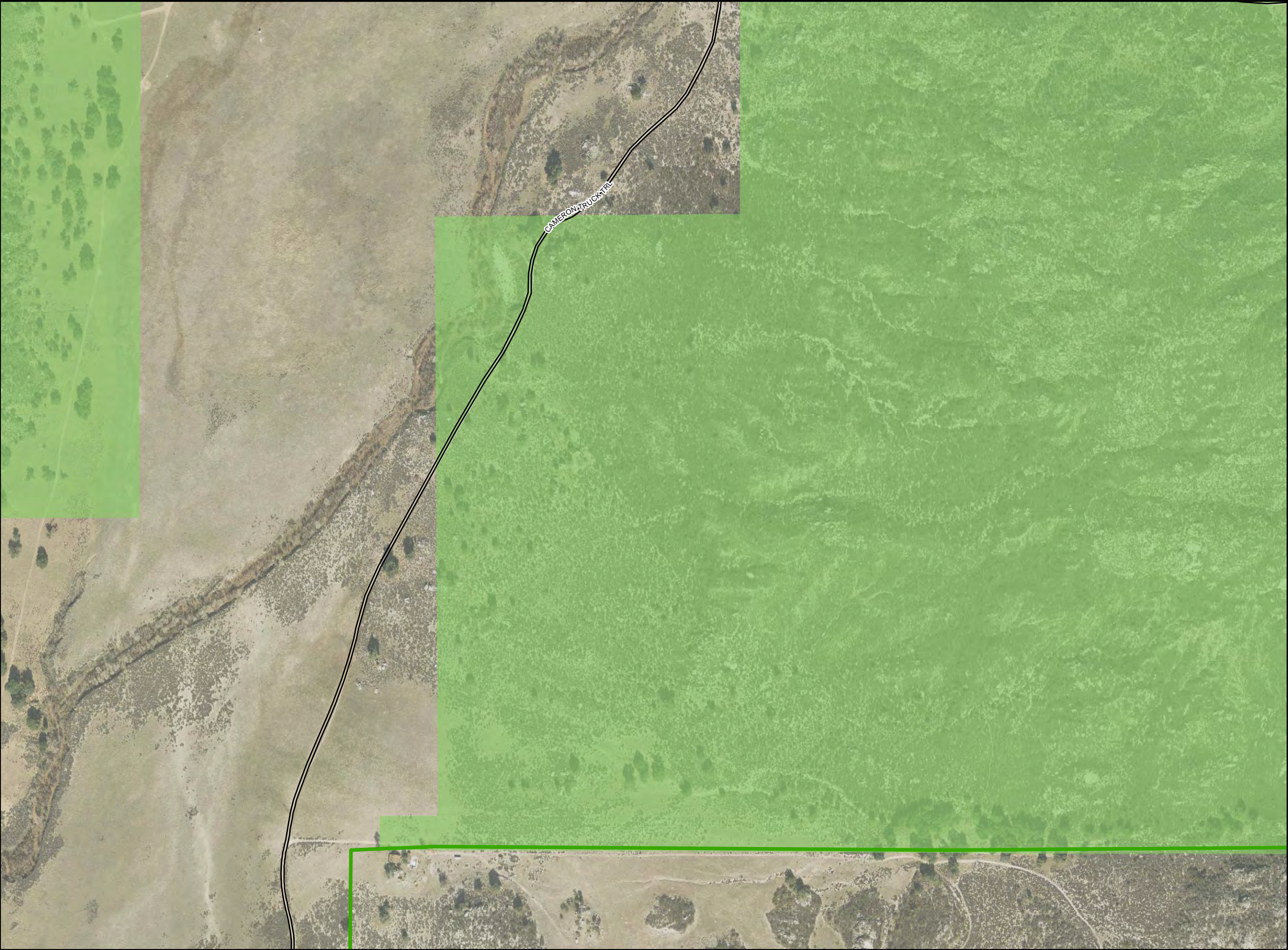

- MP-61 Mile Marker
- P16-1 Current Sunrise Structure
- Guard Structure
- TSAP (Tower Staging Access Pad)
- Existing Road Needing Major Reconstruction
- Existing Road Needing Minor Grading
- Access Road to be Constructed
- Temporary Access Road
- Existing Road Ready to Use
- Suncrest Substation
- Substation Impact Area
- Maintenance Pad
- Structure Pad Area
- Grading Limits
- Construction Yard
- Temporary Pull Site
- Structure Work Area
- Cleveland National Forest Congressional Boundary
- USFS Owned Land

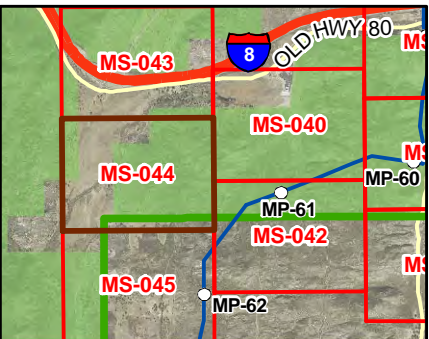
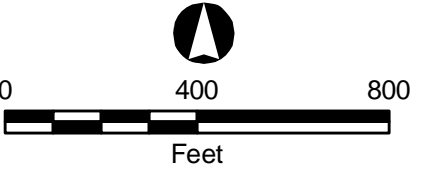

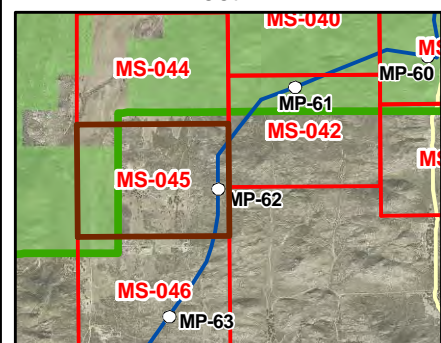
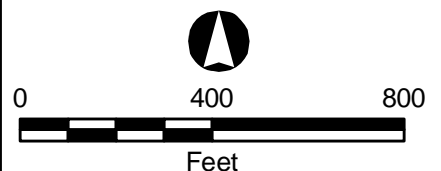
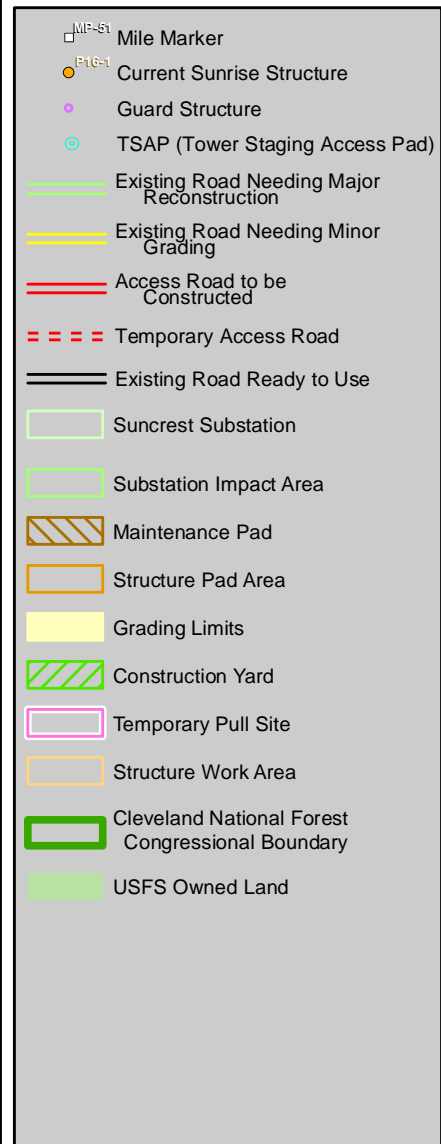

Appendix A
USFS Sensitive
Species Occurrences
MS-045 - 5/24/2010

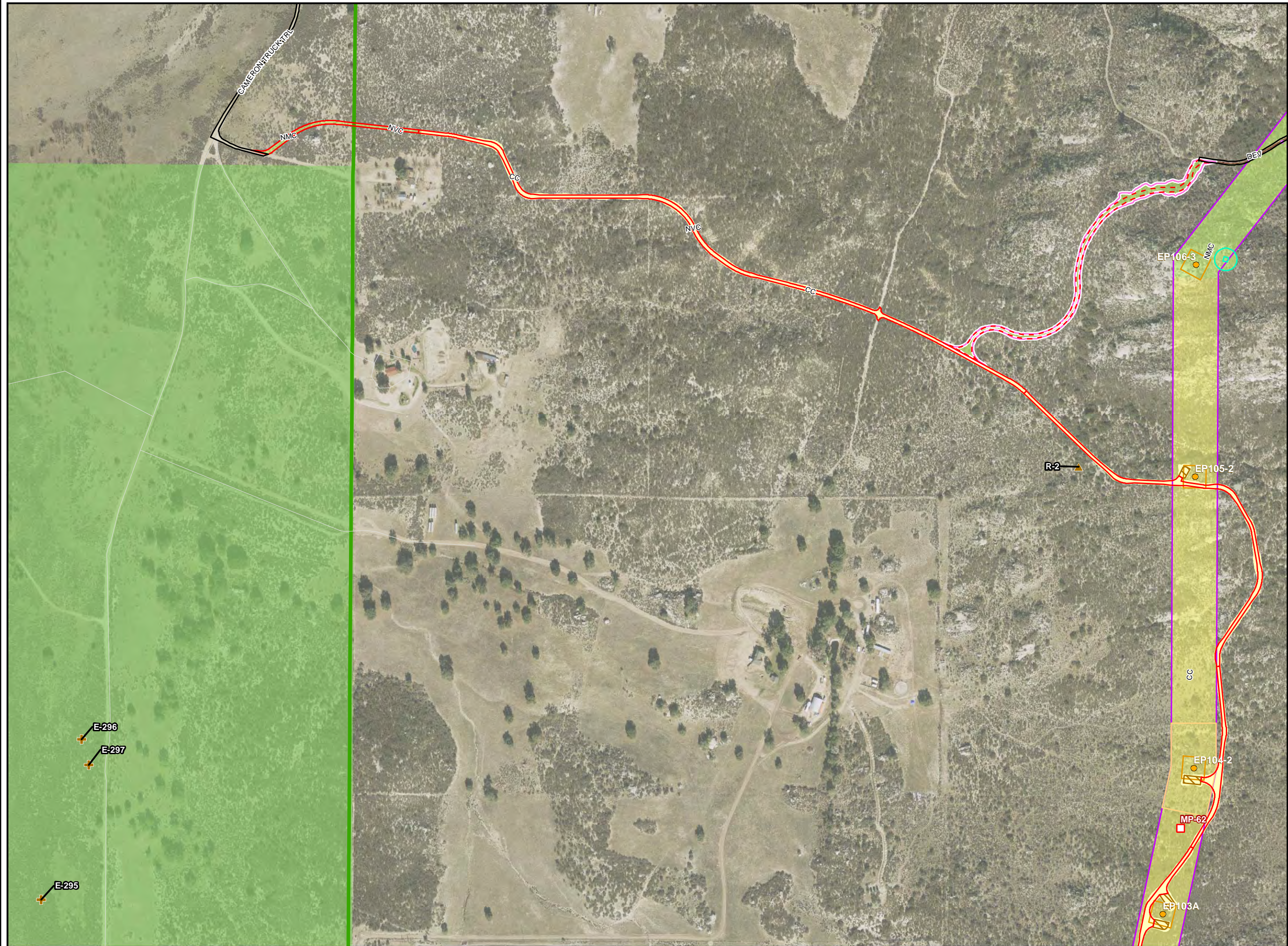

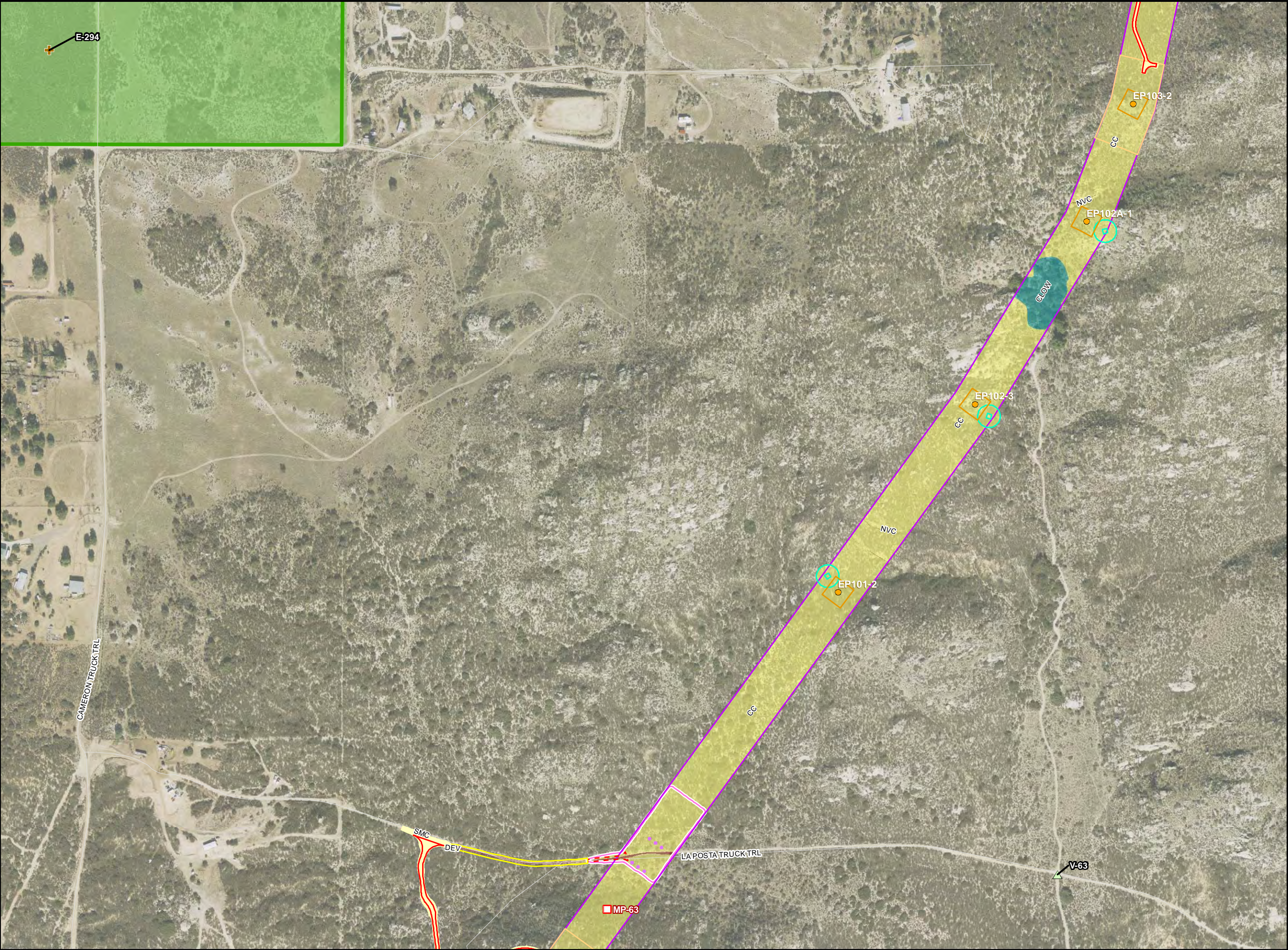

- MP-61 Mile Marker
- P10-1 Current Sunrise Structure
- Guard Structure
- TSAP (Tower Staging Access Pad)
- Existing Road Needing Major Reconstruction
- Existing Road Needing Minor Grading
- Access Road to be Constructed
- Temporary Access Road
- Existing Road Ready to Use
- Suncrest Substation
- Substation Impact Area
- Maintenance Pad
- Structure Pad Area
- Grading Limits
- Construction Yard
- Temporary Pull Site
- Structure Work Area
- Cleveland National Forest Congressional Boundary
- USFS Owned Land

